

AUTOMATIC DRAIN VALVE

IMPORTANT: READ THIS MANUAL CAREFULLY BEFORE INSTALLING, OPERATING OR SERVICING THIS EQUIPMENT.

PRESSURE RANGE

30 PSI (2 BAR) MIN. TO 175 PSI (12 BAR) MAX.

TEMPERATURE RANGE

0°F TO 125°F (-18°C TO 52°C) PLASTIC BOWL
0°F TO 200°F (-18°C TO 93°C) METAL BOWL

INSTALLATION

Automatic Drain Valve 29969-2 is for use with ARO Heavy Duty Filter 253XX-XXX.

To install: RELIEVE ALL AIR PRESSURE FROM FILTER UNIT BEFORE REMOVING BOWL.

Remove adapter (29343), washer (29345) and bowl from filter unit. Place the automatic drain valve (29969-2) into the bowl. Assemble washer (29345) and nut (Y11-110-C) to automatic drain, securing drain to bowl. Assemble snap ring (Y145-21) to groove in threaded end of drain. Assemble screen (29431) into bowl and over drain valve. Place O-ring (Y325-234) — gasket (29401) with metal bowl — on bowl and assemble bowl to filter base.

OPERATION

Water and other impurities which collect in the bottom of the bowl eventually build up raising the float (104040). The float then pushes against the rod (29506) opening the upper orifice. This allows air pressure to push the piston (29507) down and open the main valve. Water and impurities are drained off to a level that allows the float to lower, releasing pressure on rod and sealing off the top orifice.

DISASSEMBLY

RELIEVE ALL AIR PRESSURE FROM FILTER UNIT BEFORE DISASSEMBLY. Unthread nut (Y11-110-C) back against snap ring (Y145-21) and continue turning nut until drain valve and bowl are unthreaded from filter base. Remove snap ring (Y145-21), nut (Y11-110-C) and washer (29345). Remove bowl from drain valve assembly. Remove screen (29431), tubing (29510-000-A), washer (29509) and rod (29506). This will allow the valve (104037) to drop out. Unthread adapter (104038) from body (29504) allowing access to gasket (F21-37), O-ring (Y330-8), piston (29507), U-cup (Y186-46) and screen (59740).

ASSEMBLY

Lubricate O-ring (Y330-8) and U-cup (Y186-46) with 90% hydraulic or turbine oil and 10% STP and assemble to piston (29507). Assemble piston and gasket (F21-37) to body (29504). Thread body to adapter (104038) and tighten 20 to 25 ft. lbs. torque. Position valve (104037) into adapter (104038) and insert rod (29506) thru adapter and valve. Secure rod to adapter with washer (29509) and tubing (29510-000-A). Assemble drain assembly to bowl and secure with washer (29345), nut (Y11-110-C) and snap-ring (Y145-21). Assemble screen (29431) to unit and assemble to filter base.

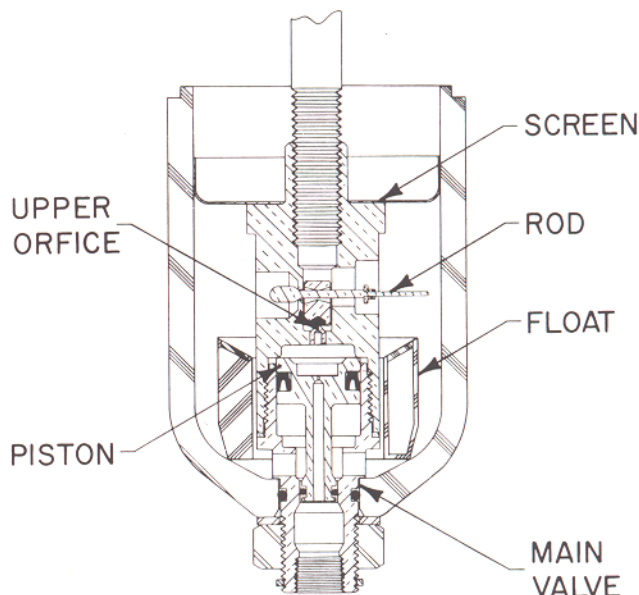

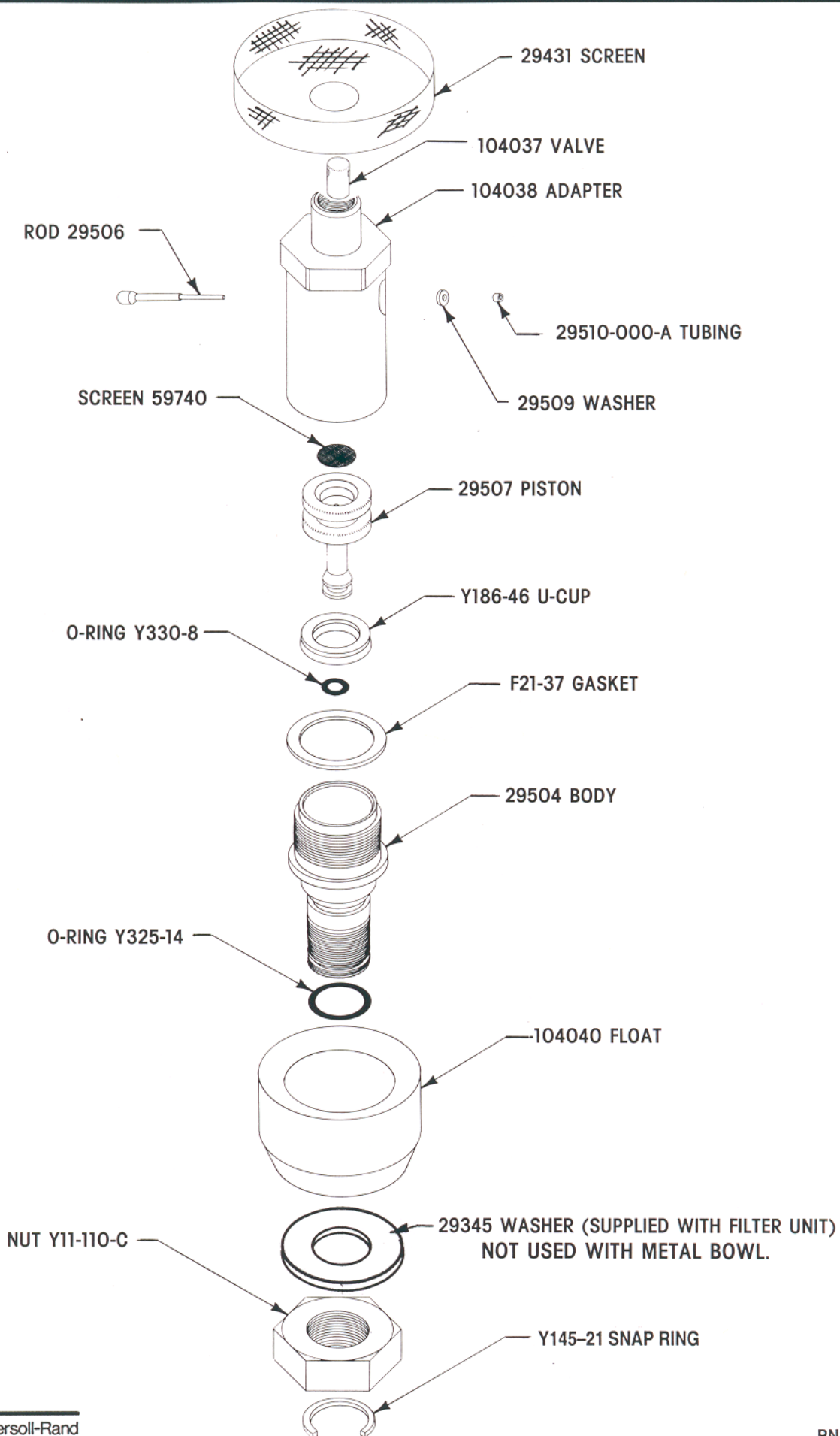

Part of worldwide Ingersoll-Rand

PN103950